

Technical data sheet for  
**BENCH TOPS 900mm**  
 B90-CB, B90-LS, B90-RB

- Heavy-duty construction
- Cabinet Base, Leg Stand or Refrigerated Base
- Stainless steel exterior
- Easy clean
- Fully modular

**Overall Construction**

**Bench Top**

- 3.5mm thick compound work surface
  - 1.5mm 304 stainless steel top
  - 2.0mm galvanised steel backing
- Welded 1.5mm stainless steel bull nose
- Splashback and side panels 1.2mm stainless steel

**Cabinet Base (supplied as -CB model)**

- Modular for suite matched finish
- Double skin 0.9mm stainless steel interior and exterior
- GN 1/1 4 position racking kit
- 63mm dia. heavy-duty 1.2mm stainless steel legs with adjustable feet

**Leg Stand (Supplied as -LS model)**

- Modular for suite matched finish
- 63mm dia. heavy-duty 1.2mm stainless steel legs with adjustable feet
- Framed stand shelf with 0.9mm stainless steel finish
- Quick assembly design (no tools required)

**Refrigerated Base (supplied as -RB model)**

- Self contained suite matched modular base
- Ventilated system with R134a refrigerant
- -2° to + 8°C temperature (Tropical Climate rated)
- Two GN 1/1 drawers
- 100mm deep pan capacity
- Heavy-duty European telescopic drawer guides
- Magnetic drawer gaskets (replaceable without tools)
- 50mm fully foamed CFC free insulation
- 304 stainless steel exterior and interior
- Anti-corrosion treated evaporator
- No condensate drain required
- 63mm dia. heavy-duty 1.2mm 304 stainless steel legs with adjustable feet
- Condensing unit removable through front of unit for service
- Easy clean interior
- Digital control electronic thermostat
- Automatic defrost
- Automatic evaporation of defrost water
- -2° to +8°C temperature range



B90-CB



B90-LS



B90-RB

# Technical data sheet for BENCH TOPS 900mm

## Specifications

### Dimensions

Width 900mm  
Depth 812mm  
Height 915mm  
Incl. splashback 1085mm

### Nett weight

**Cabinet Base models**  
88kg

**Leg Stand models**  
70kg

**Refrigerated Base models**  
116kg

### Packing data

**Cabinet Base models**  
1.02m<sup>3</sup>, 153kg  
Width 945mm  
Depth 870mm  
Height 1260mm

**Leg Stand models**  
0.54m<sup>3</sup>, 120kg  
Width 945mm  
Depth 870mm  
Height 665mm

**Refrigerated Base models**  
1.02m<sup>3</sup>, 181kg  
Width 945mm  
Depth 870mm  
Height 1260mm

### Refrigerated Base Type

Ventilated system

### Refrigerant

R134a (160grams)

### Climate classification

T – tropical

### Electrical connection

220-240Vac, 50Hz, 1.8A, 1P+N+E  
3 pin 10A plug cordset fitted

### Options at extra cost

Castors

### B90-CB

#### Cabinet Base

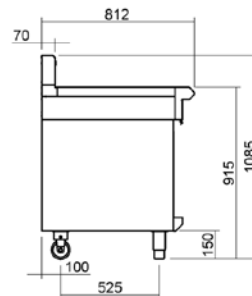
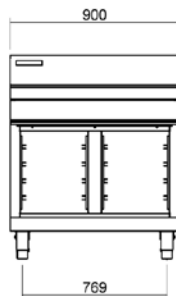

### B90-LS

#### Leg Stand

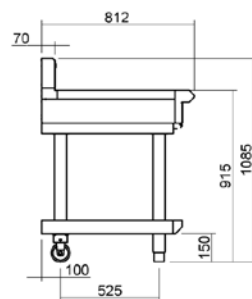
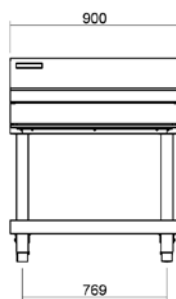

### B90-RB

#### Refrigerated Base

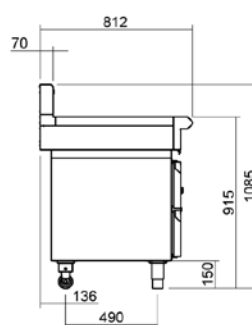

### B90



**BLUE SEAL**

[www.blue-seal.co.uk](http://www.blue-seal.co.uk)

[www.bluesealevolution.com](http://www.bluesealevolution.com)

### United Kingdom

#### Blue Seal Limited

Unit 67

Gravelly Business Park

Gravelly

Birmingham B24 8TQ

England

Telephone 0121-327 5575

Facsimile 0121-327 9711

Email [sales@blue-seal.co.uk](mailto:sales@blue-seal.co.uk)

[www.blue-seal.co.uk](http://www.blue-seal.co.uk)

### Australia

#### Moffat Pty Limited

740 Springvale Rd

Mulgrave

Victoria 3170

Australia

Telephone 03-9518 3888

Facsimile 03-9518 3833

Email [vsales@moffat.com.au](mailto:vsales@moffat.com.au)

[www.moffat.com.au](http://www.moffat.com.au)

### New Zealand

#### Moffat Limited

16 Osborne St

PO Box 10-001

Christchurch 8011

New Zealand

Telephone 03-389 1007

Facsimile 03-389 1276

Email [sales@moffat.co.nz](mailto:sales@moffat.co.nz)

[www.moffat.co.nz](http://www.moffat.co.nz)



ISO9001

Quality  
Management  
Standard

Designed and manufactured by

**MOFFAT**

ISO9001

All Blue Seal products are designed and manufactured by Moffat using the internationally recognised ISO9001 quality management system, covering design, manufacture and final inspection, ensuring consistent high quality at all times.



In line with policy to continually develop and improve its products, Moffat Limited reserves the right to change specifications and design without notice.